



INSTRUCCIONES | INSTRUCTIONS | INSTRUCTIONS

CE

LOGIC/SQUARE

¿Qué necesito? | What do I need? | De quoi ai-je besoin?

Incluido | Included | Compris

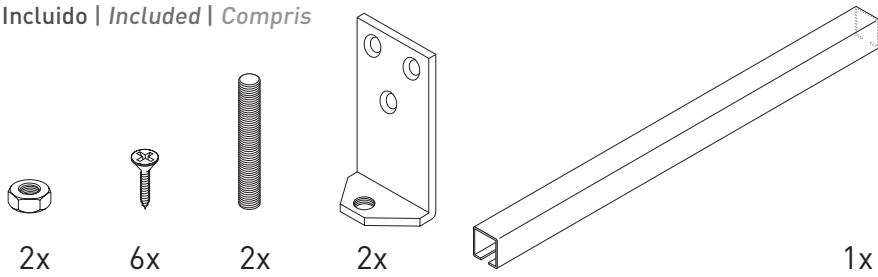

No incluido | Not included | Pas compris

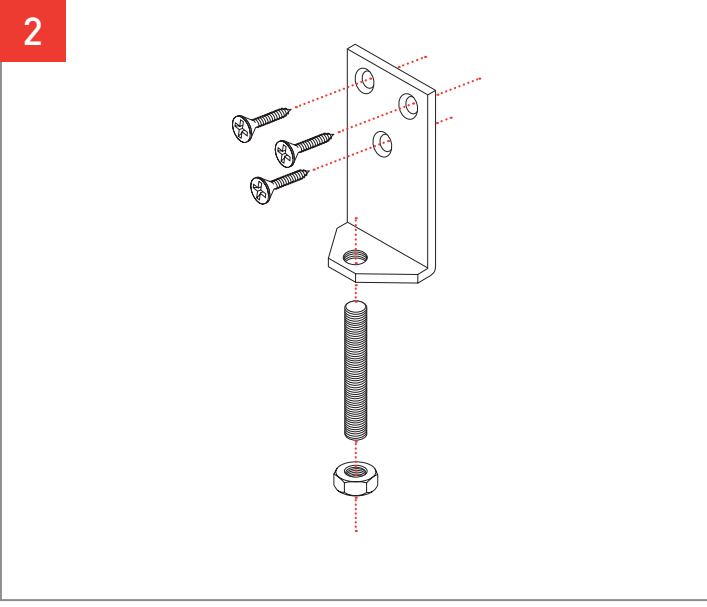
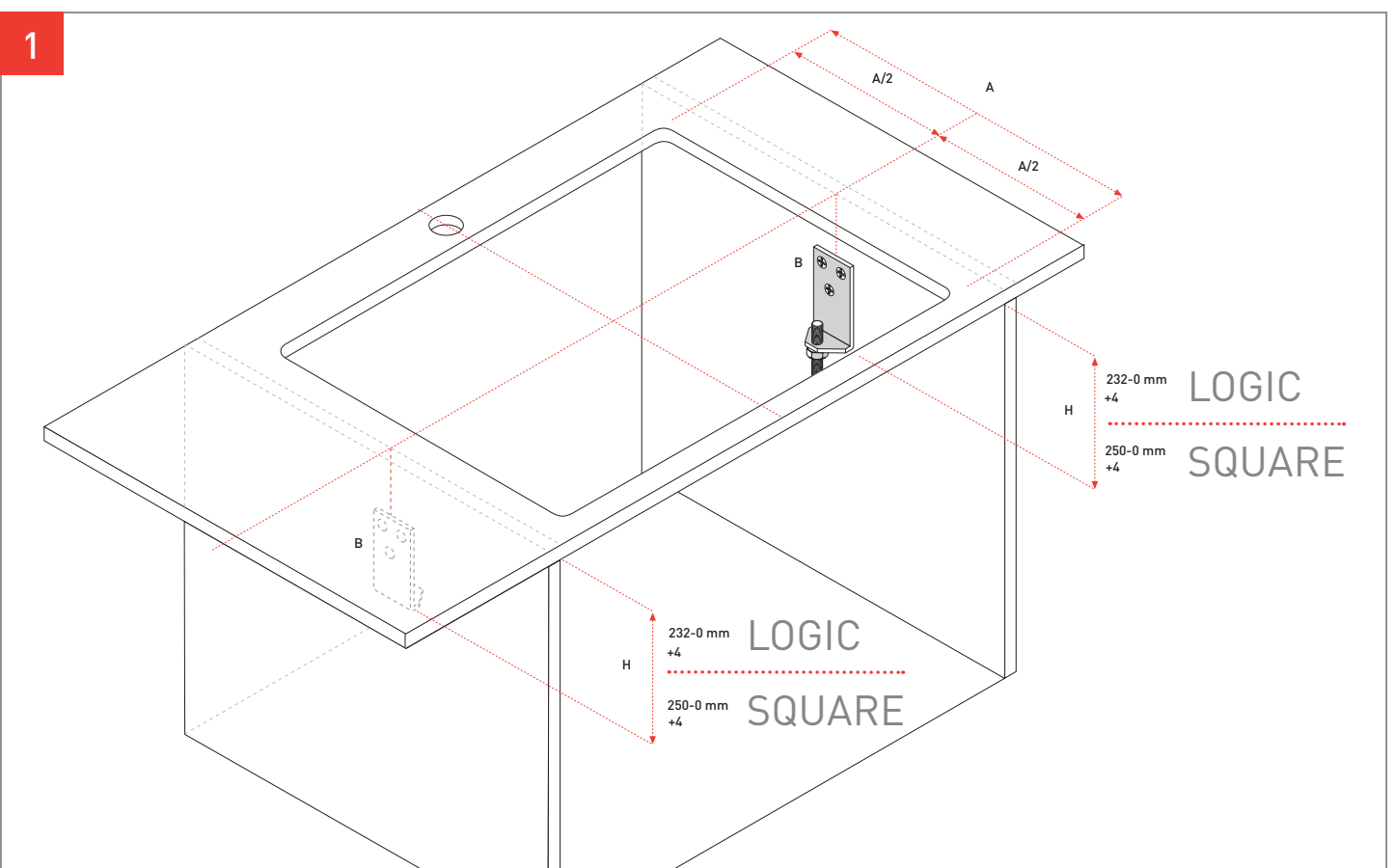
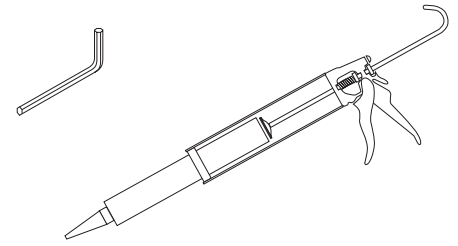

¿Qué tengo que hacer? | What should I do? | Qu'est-ce que je dois faire?

Según la medida del mueble puede haber más de una barra
 Different types of bars may be available depending on the cabinet size
 Selon les dimensions du meuble il peut y avoir plus d'une barre

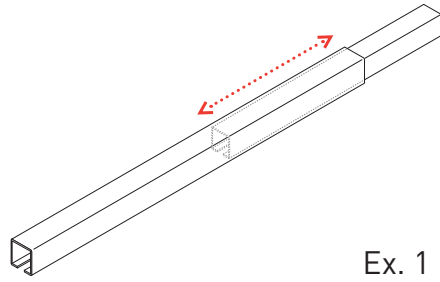

Ex. 1

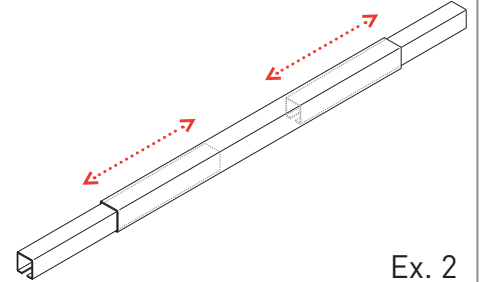

Ex. 2

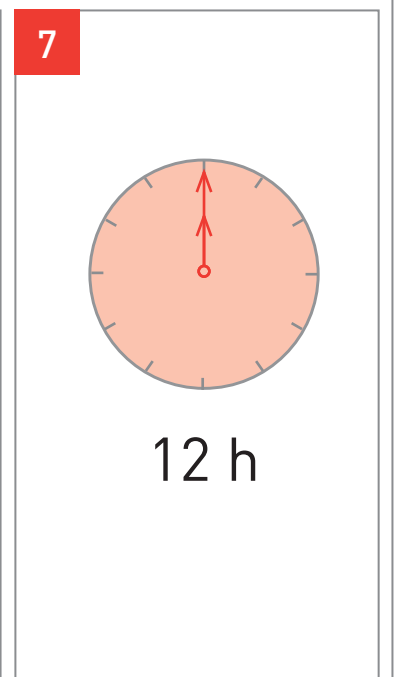
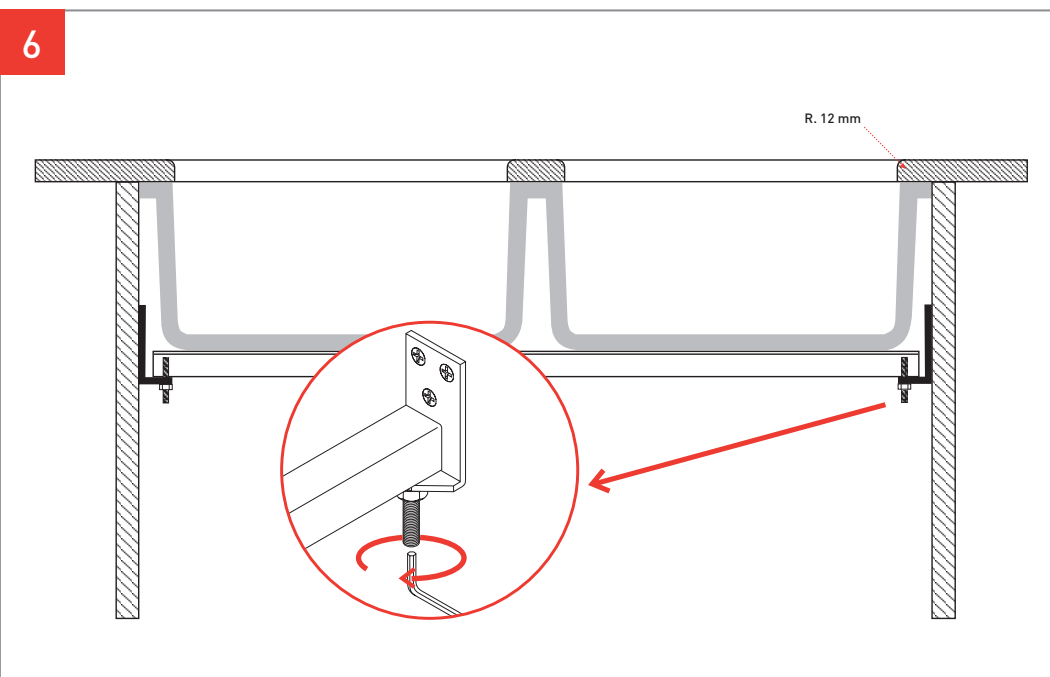
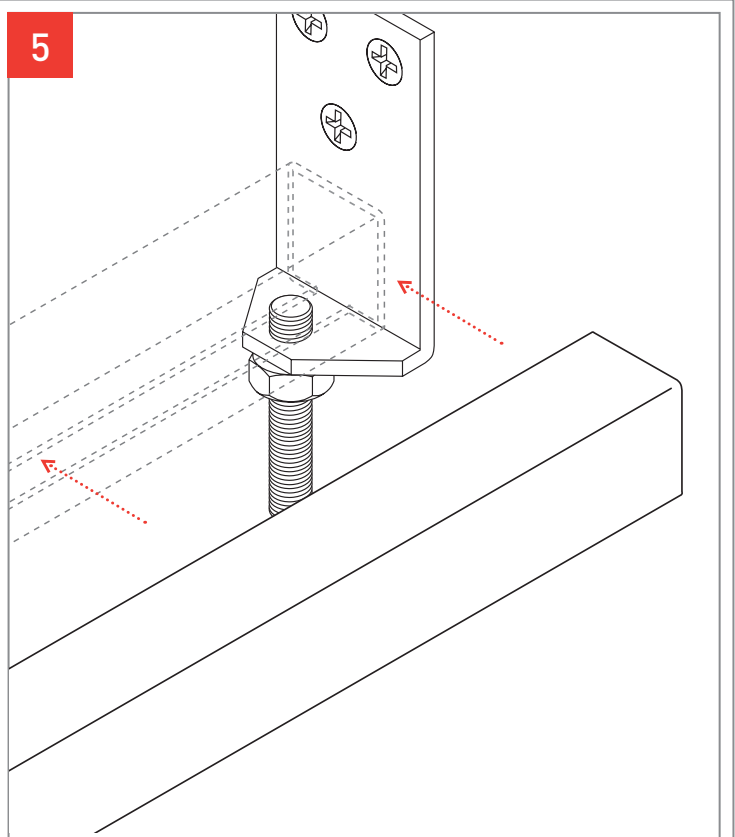
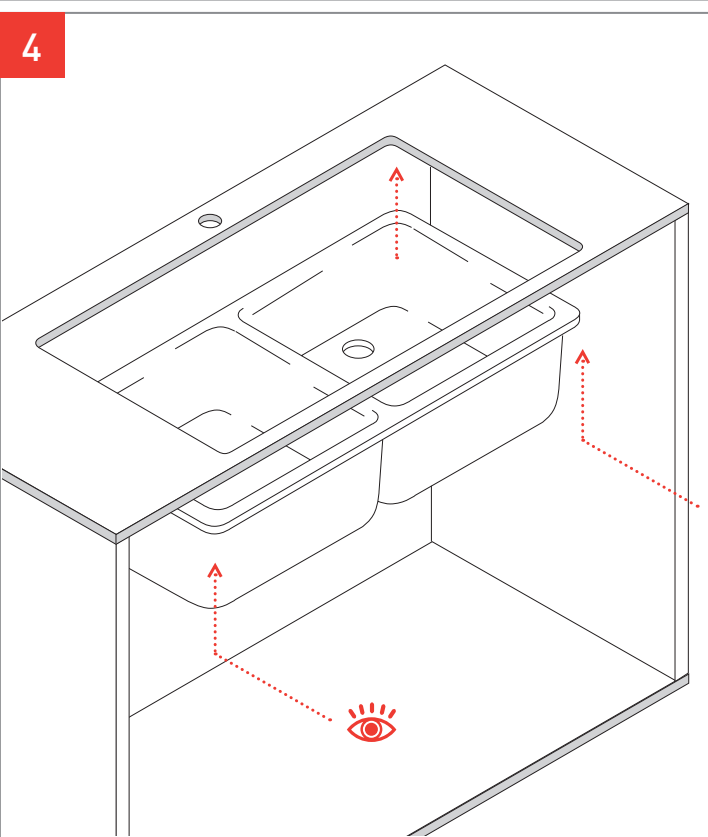

LOGIC CORNER

¿Qué necesito? | What do I need? | De quoi ai-je besoin?

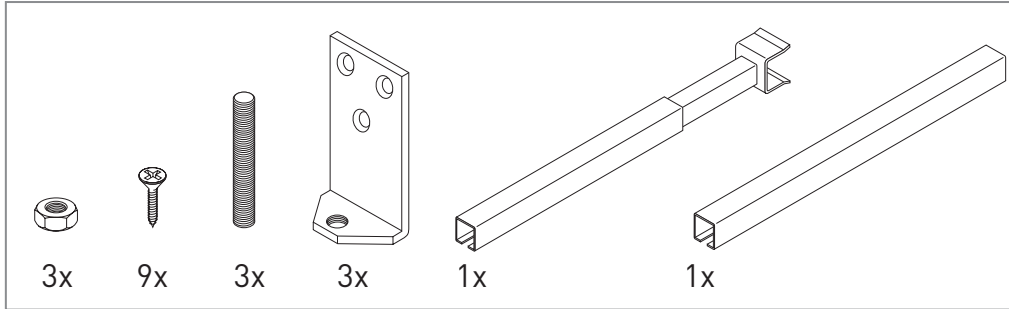

No incluido | Not included | Pas compris

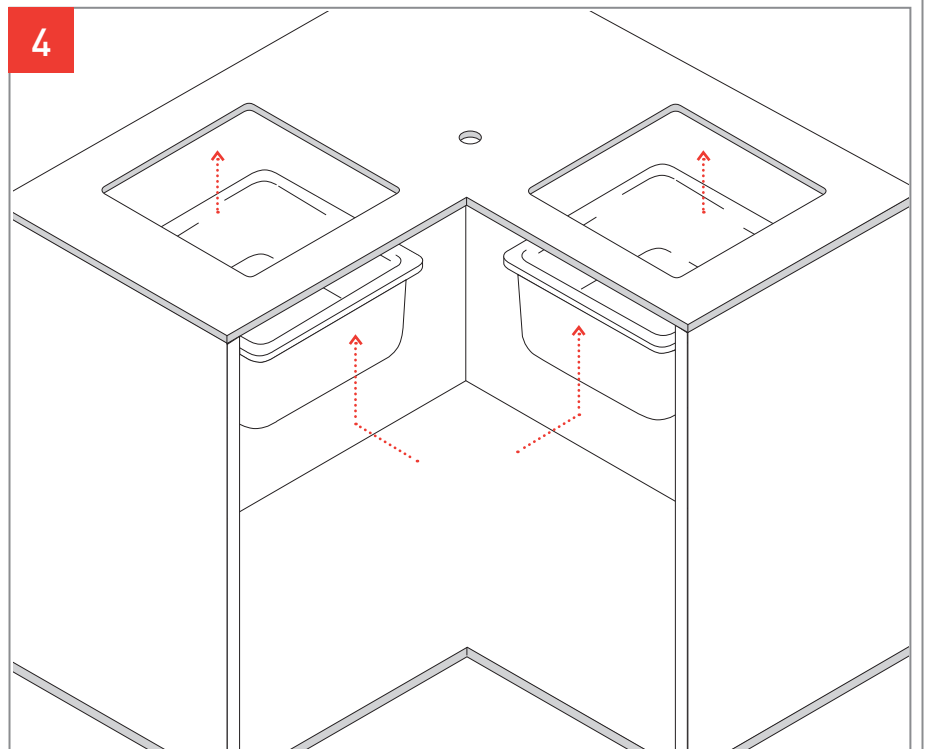
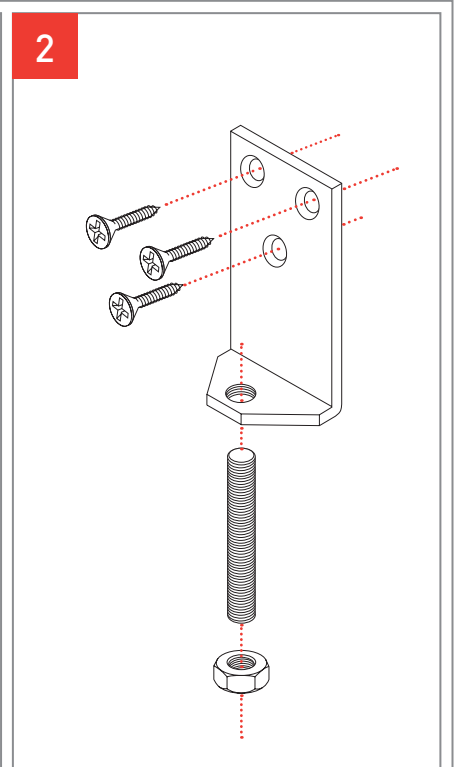
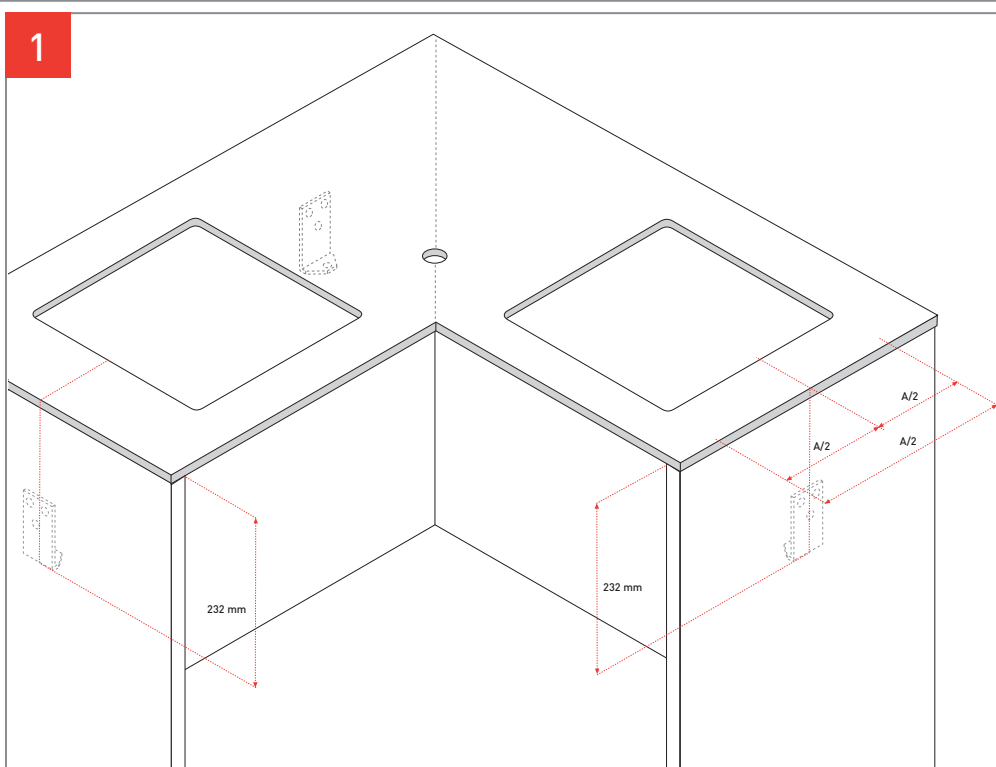
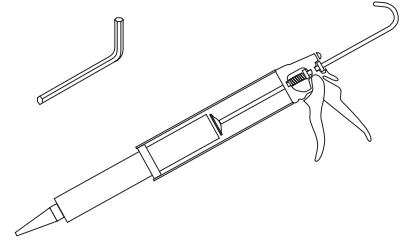

¿Qué tengo que hacer? | What should I do? | Qu'est-ce que je dois faire?

Según la medida del mueble puede haber más de una barra

Different types of bars may be available depending on the cabinet size

Selon les dimensions du meuble il peut y avoir plus d'une barre

Incluido | Included | Compris

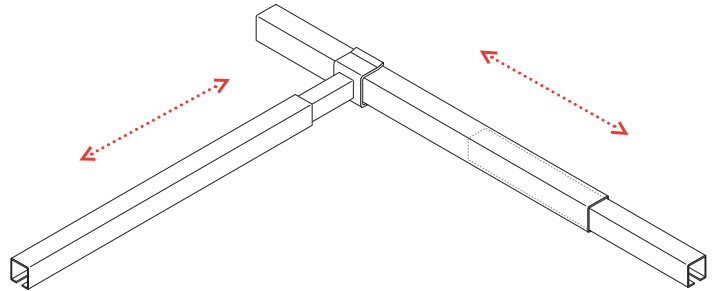

5

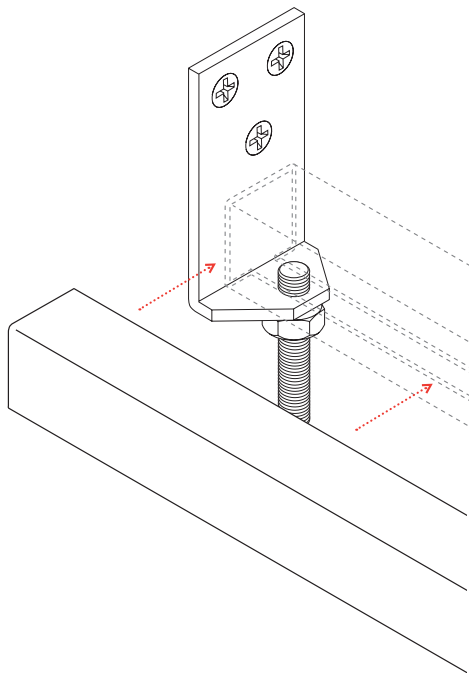

6

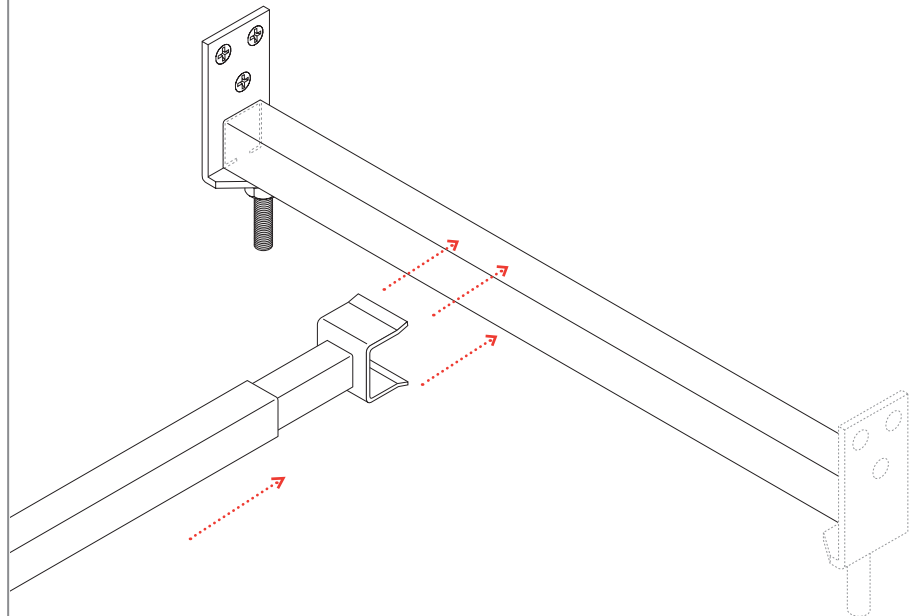

7

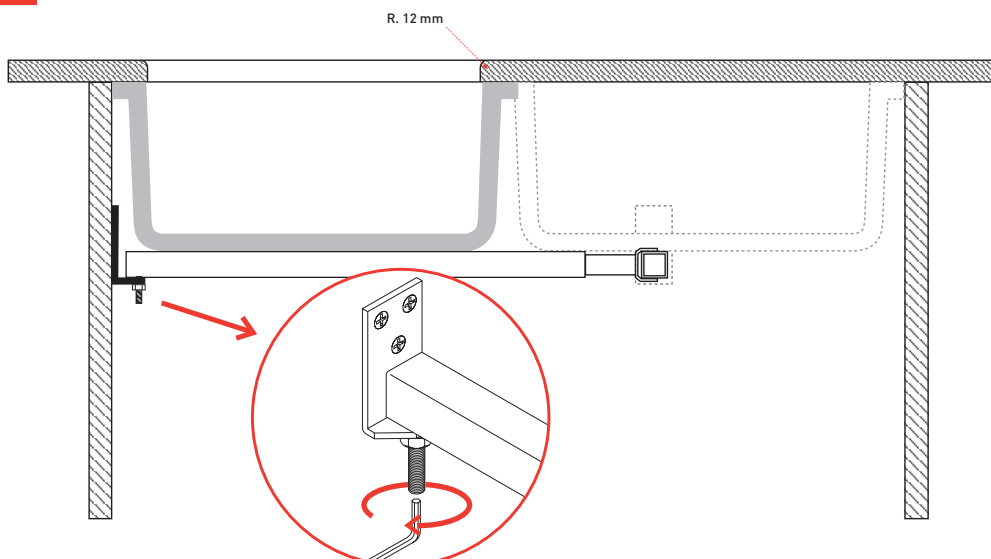

8

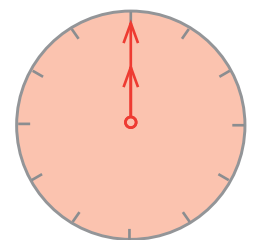

12 h

TREND / CLASSIC

¿Qué necesito? | What do I need? | De quoi ai-je besoin?

No incluido | Not included | Pas compris

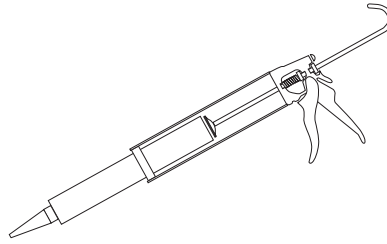
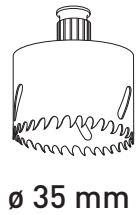
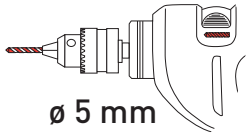

1

Instrucciones para hacer el orificio para la instalación del grifo. Si no es necesario, pasar al punto 4 directamente.
Instruction for drilling the faucet fitting hole. If not required, skip directly to step 4.
 Instructions pour faire le trou pour l'installation du robinet. Si ce n'est pas nécessaire, passez à l'étape 4 directement

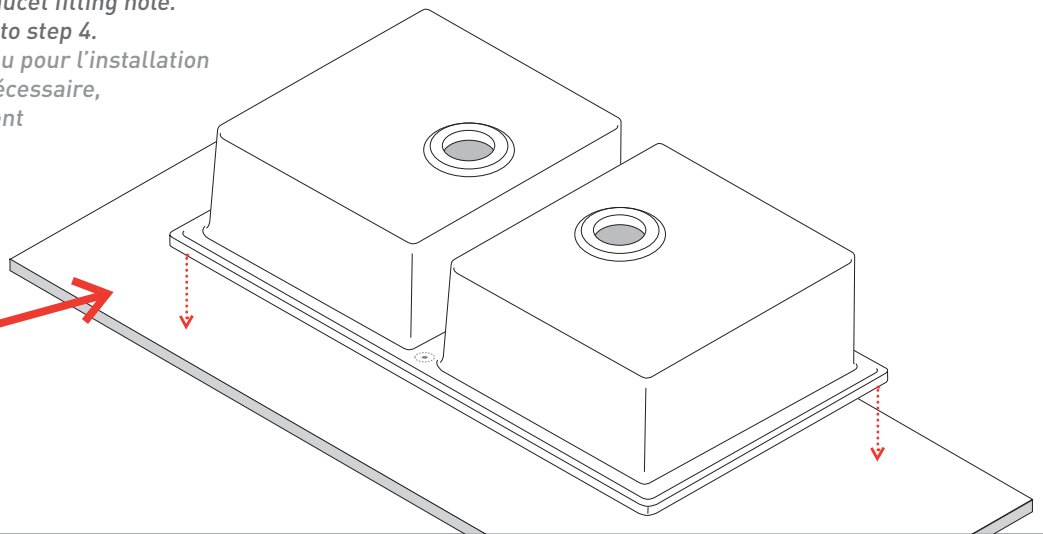

2

Sólo en caso necesario
 Only if necessary
 Seulement si nécessaire

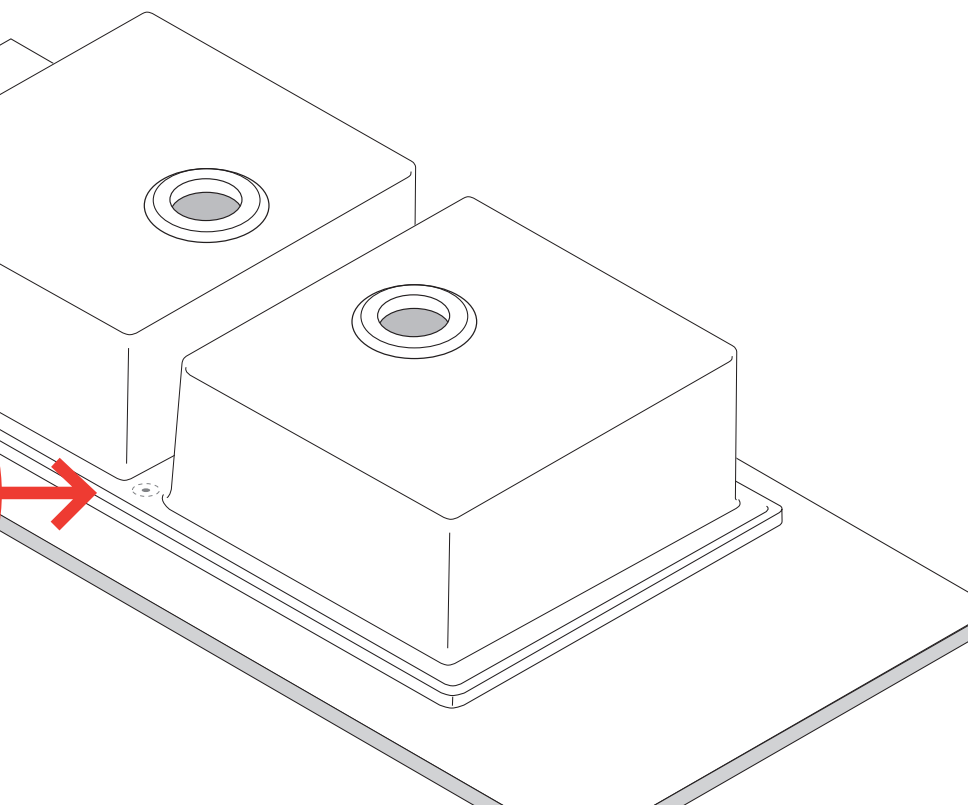
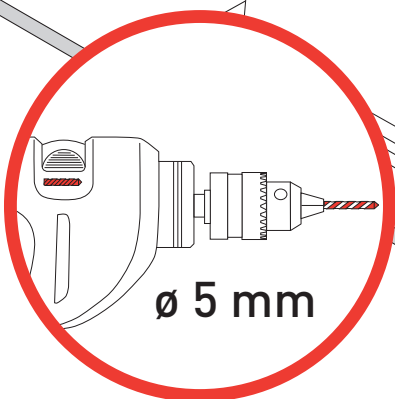

¿Qué tengo que hacer? | What should I do? | Qu'est-ce que je dois faire?



3

Sólo en caso necesario
Only if necessary
Seulement si nécessaire

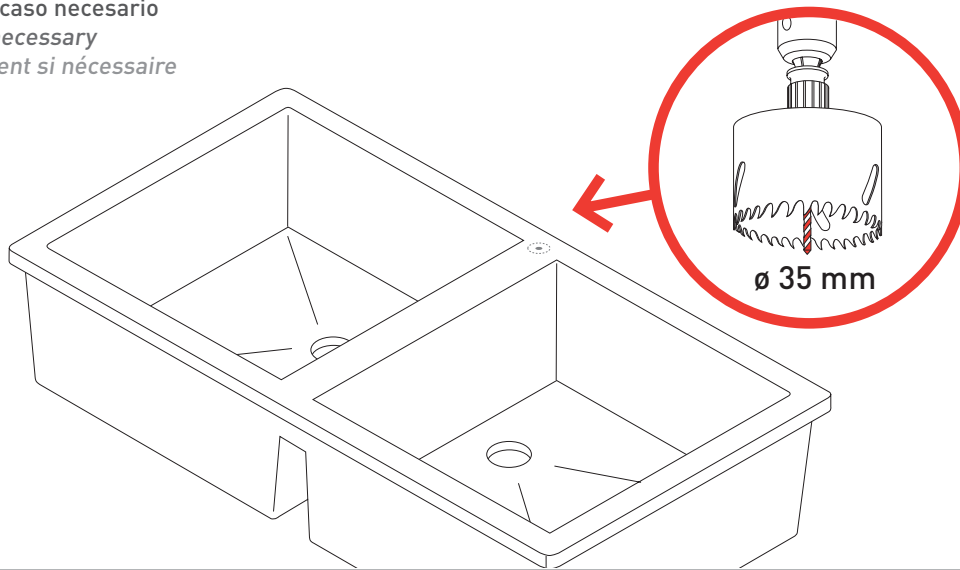

4

Silicona no incluida
Silicone not included
Silicone pas comprise

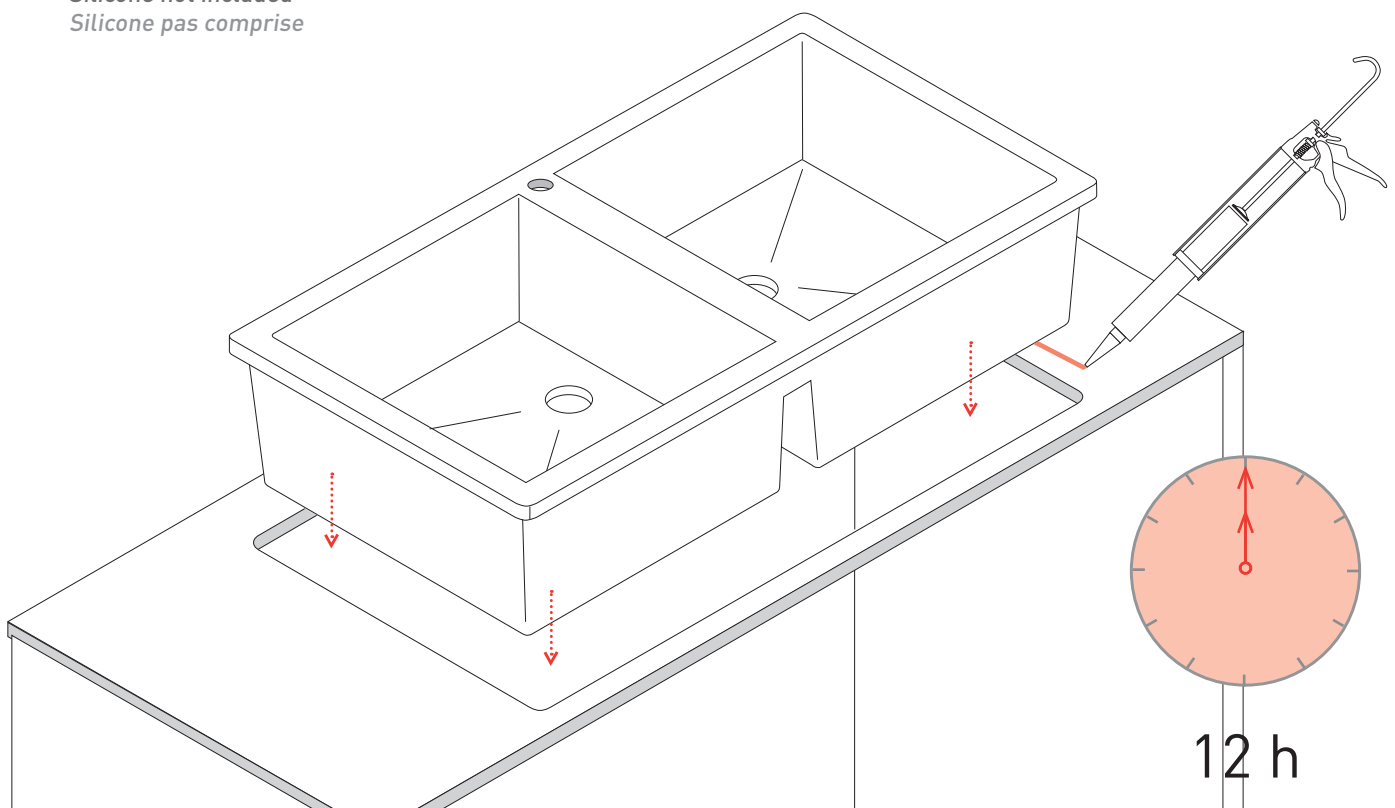

CLASSIC delfos

¿Qué necesito? | What do I need? | De quoi ai-je besoin?

1

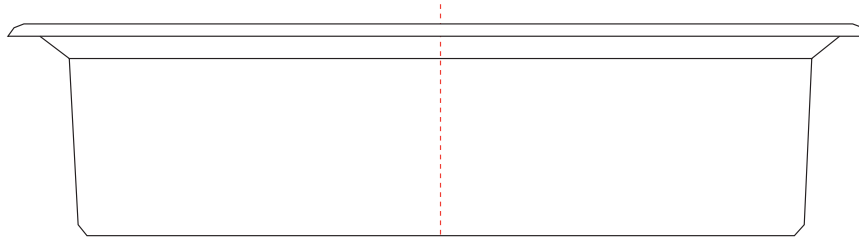

aprox. 2,5 cm

aprox. 2,5 cm

*Centrar plantilla con el mueble
para cortar la encimera*

*Center the template on the cabinet
before cutting the worktop*

*Centrer le modèle sur le meuble
pour couper le plan de travail*

60 cm

**Medida de mueble calculada
con tablero de 16 mm (grosor)
y encimera de 40 mm**

*Cabinet size includes 16mm board
(thickness) and 40mm worktop*

*Dimensions du meuble calculées
avec planche de 16 mm (large)
et plan de travail de 40 mm*

CLASSIC minerva

¿Qué tengo que hacer? | What should I do? | Qu'est-ce que je dois faire?

1

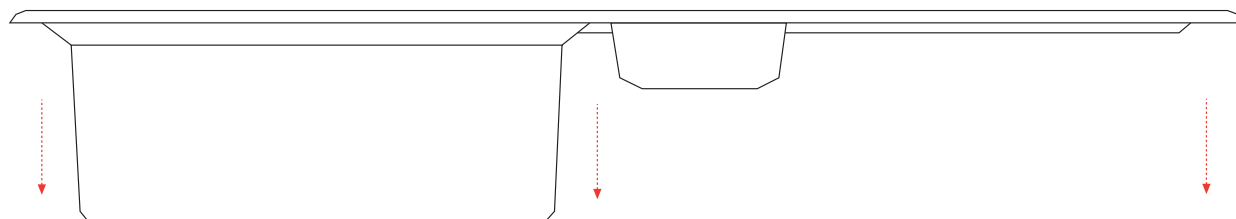

2 cm



*Desplazar la plantilla
para cortar la encimera*

*Move the template before
cutting the worktop*

*Déplacer le modèle avant
couper le plan de travail*

50 cm



*Medida de mueble calculada
con tablero de 16 mm (grosor)
y encimera de 40 mm*

*Cabinet size includes 16mm board
(thickness) and 40mm worktop*

*Dimensions du meuble calculées
avec planche de 16 mm (large)
et plan de travail de 40 mm*



LOGIC

Para más información | For more information | Pour plus de renseignements: www.atron-europa.com

MÓDULO | MODULE 45 cm

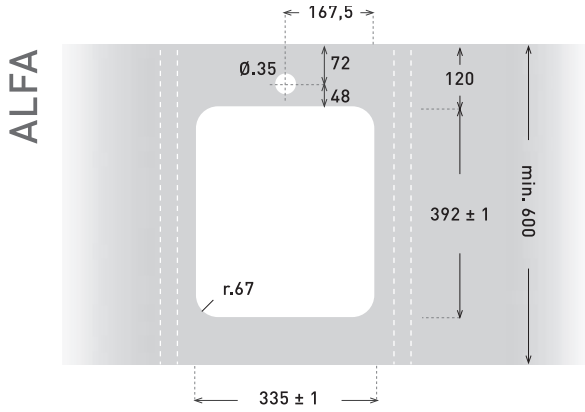

MÓDULO | MODULE 50 cm

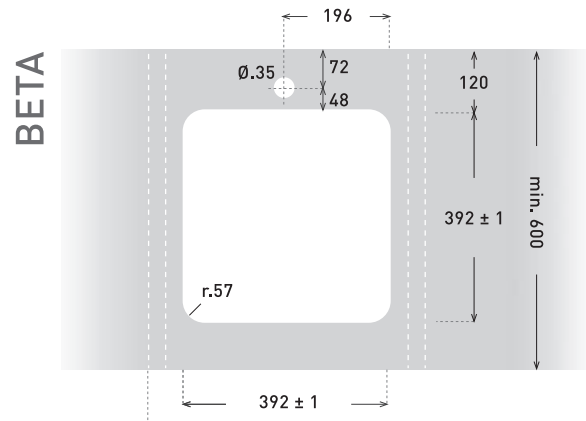
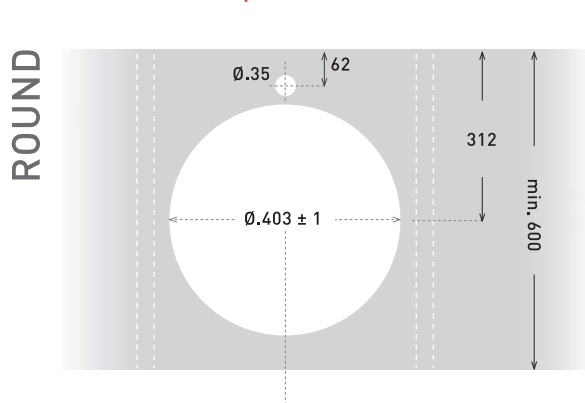

MÓDULO | MODULE 80 cm

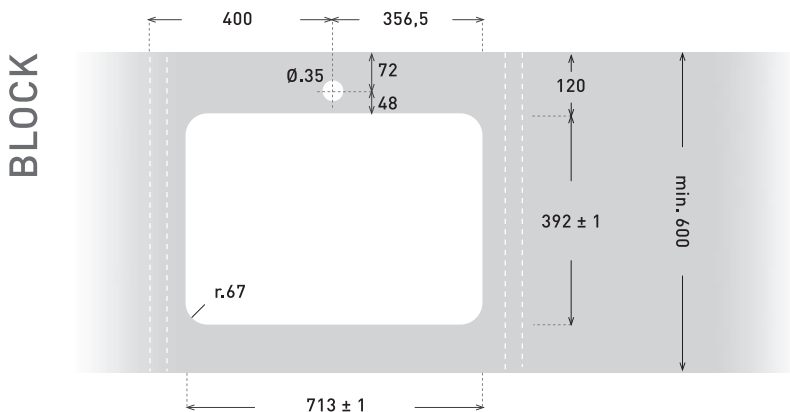

LOGIC

Para más información | For more information | Pour plus de renseignements: www.atron-europa.com

MÓDULO | MODULE 90 cm

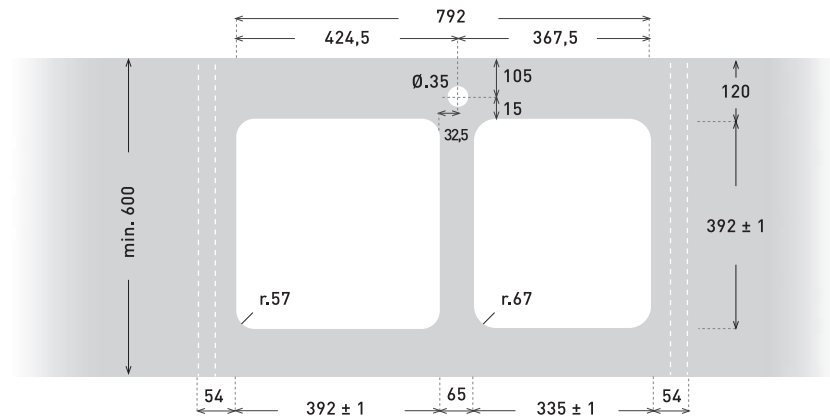

COMBINED left

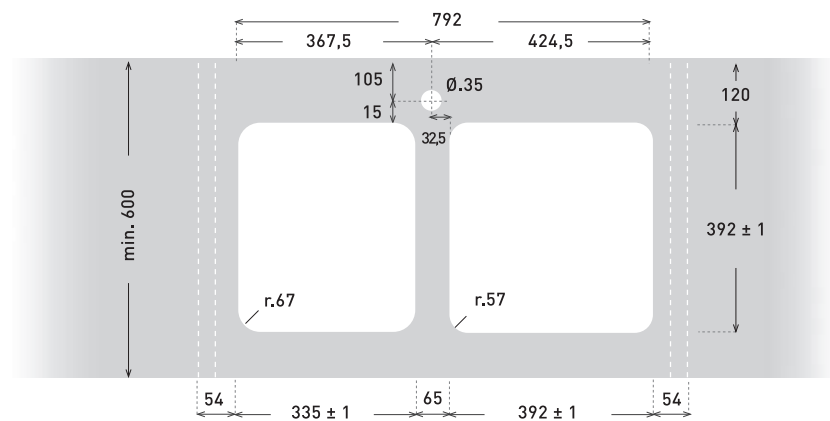

COMBINED right

MÓDULO | MODULE 90 x 90 cm

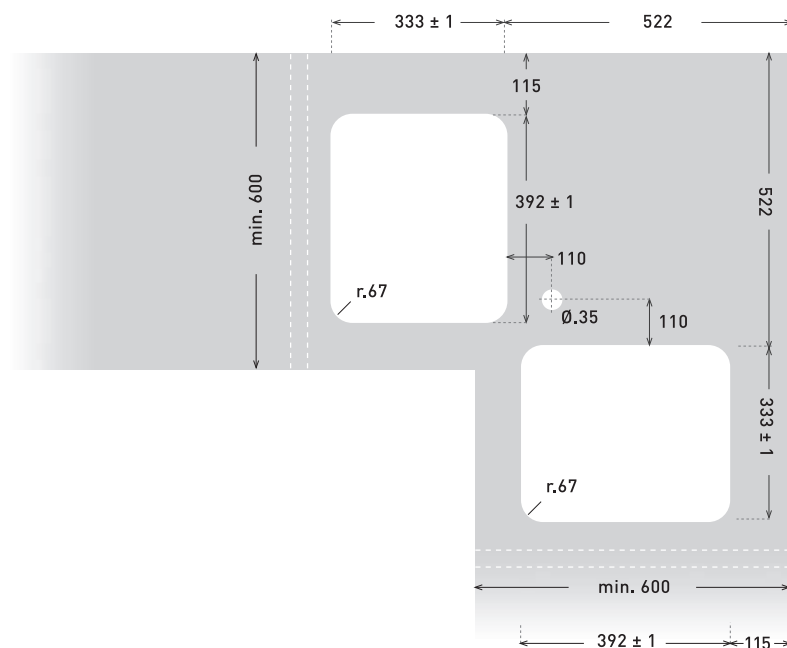

CORNER

SQUARE

Para más información | For more information | Pour plus de renseignements: www.atron-europa.com

MÓDULO | MODULE 45 cm

MÓDULO | MODULE 50 cm

LAKE

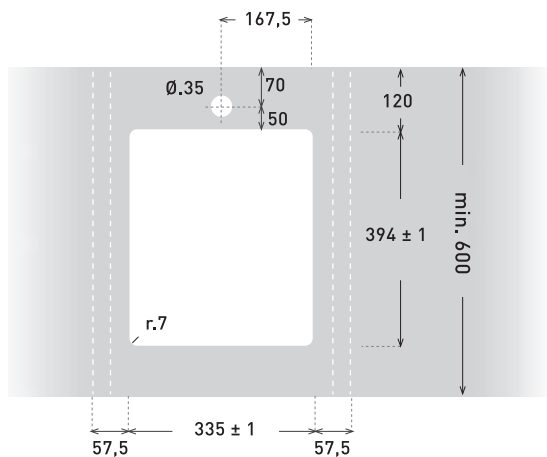

SEA

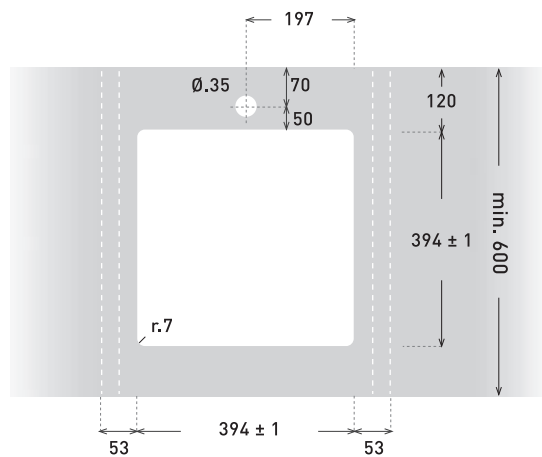

MÓDULO | MODULE 60 cm

OCEAN

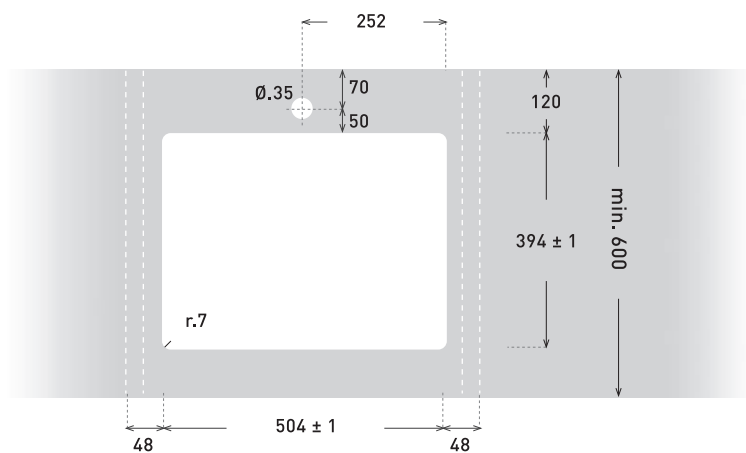

STREAM

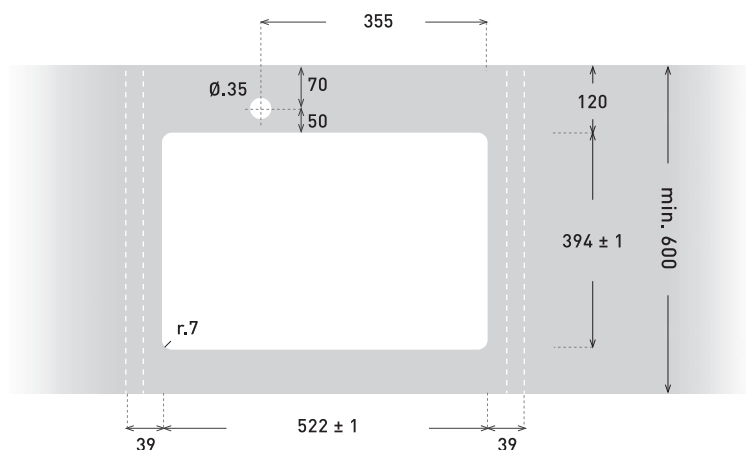

SQUARE

Para más información | For more information | Pour plus de renseignements: www.atron-europa.com

MÓDULO | MODULE 80 cm

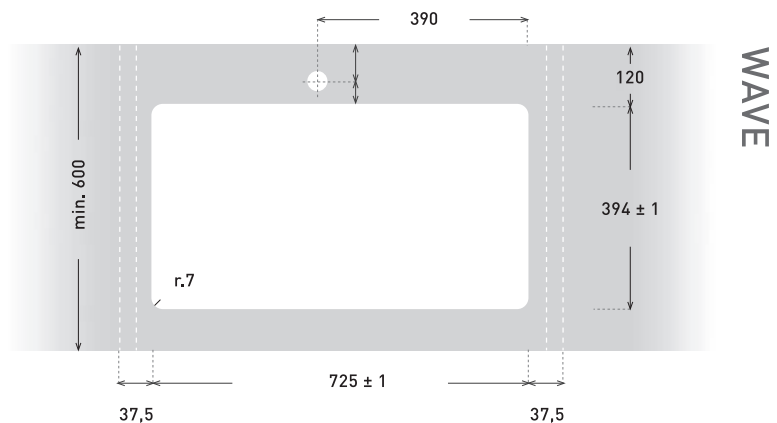
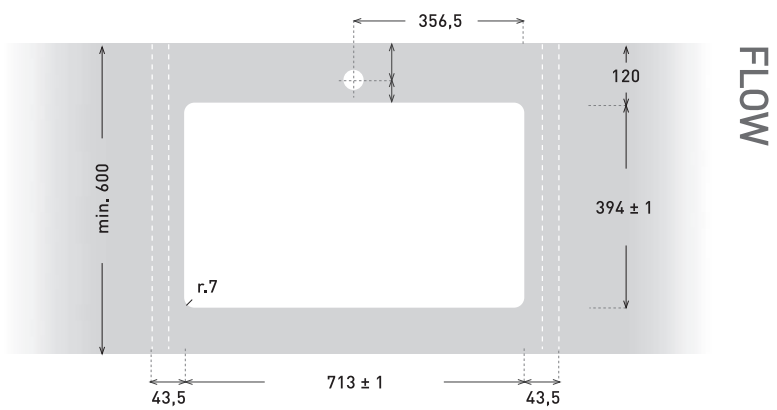
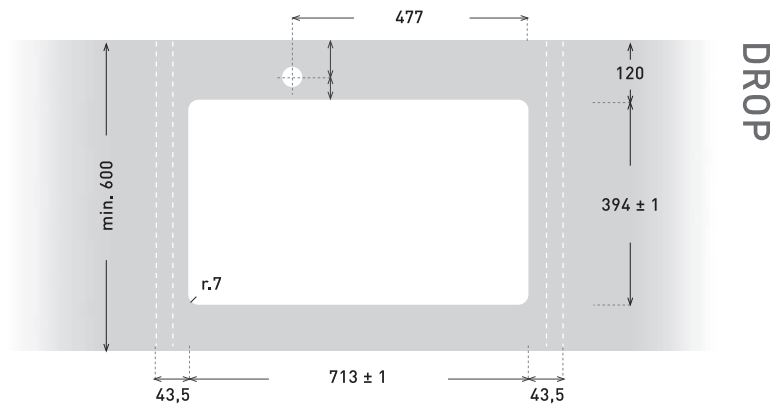
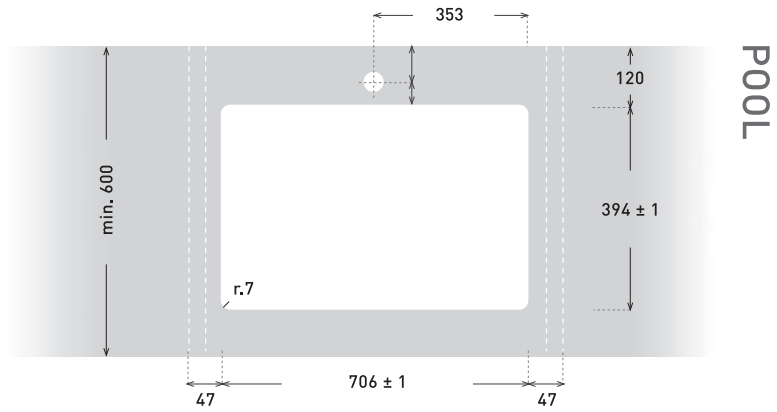

SQUARE

Para más información | For more information | Pour plus de renseignements: www.atron-europa.com

MÓDULO | MODULE 80 cm

LAKE + LAKE

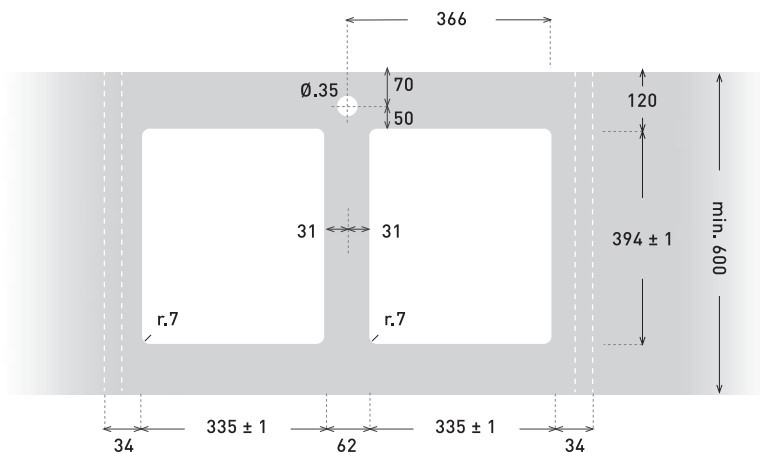

RIVER + SEA

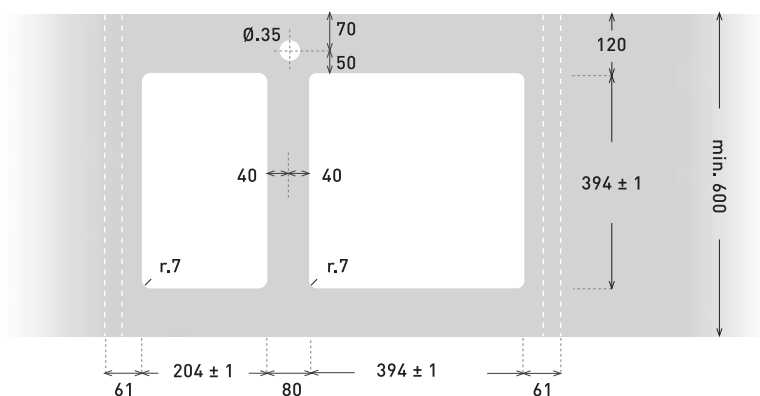

MÓDULO | MODULE 90 cm

DELTA

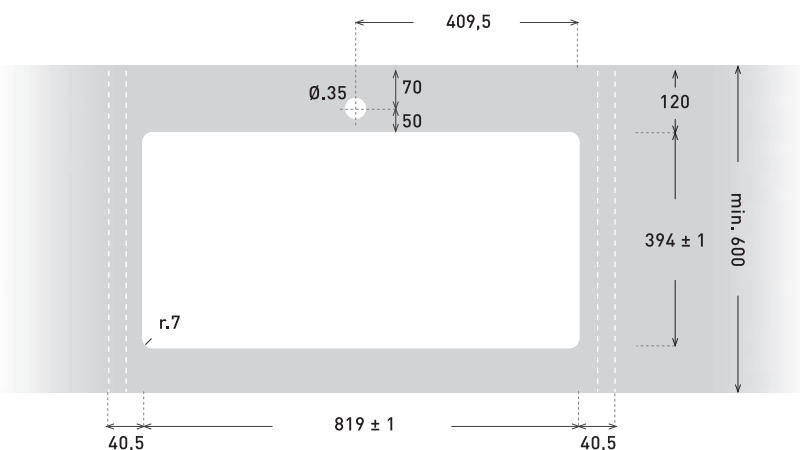

SQUARE

Para más información | For more information | Pour plus de renseignements: www.atron-europa.com

MÓDULO | MODULE 90 cm

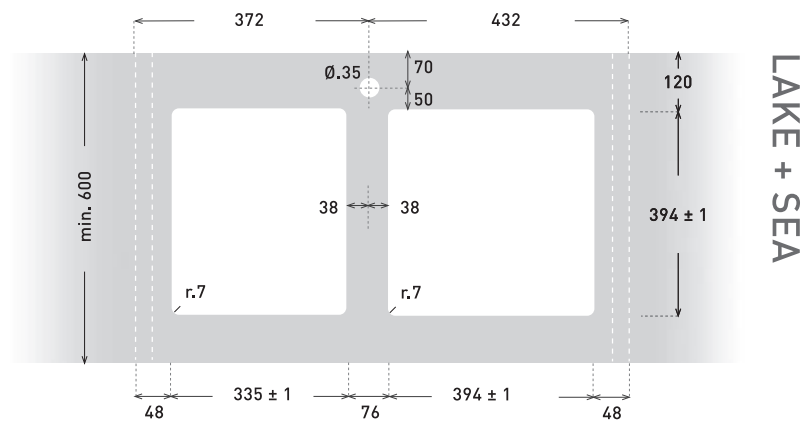
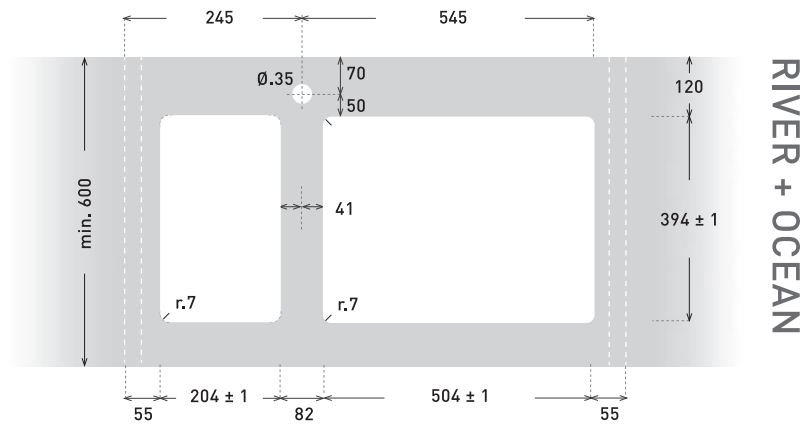

MÓDULO | MODULE 90 x 90 cm

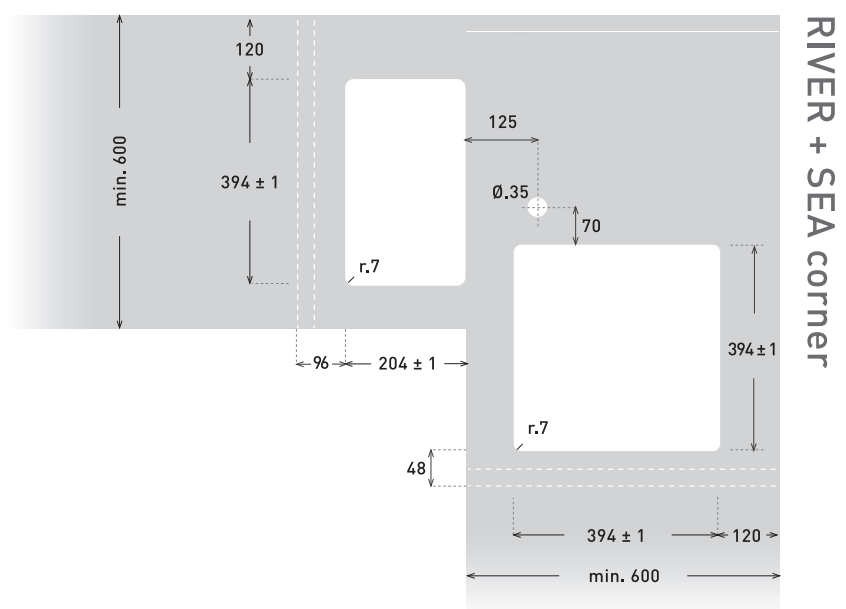

Para más información | For more information | Pour plus de renseignements: www.atron-europa.com

MÓDULO | MODULE 50 cm

GEA

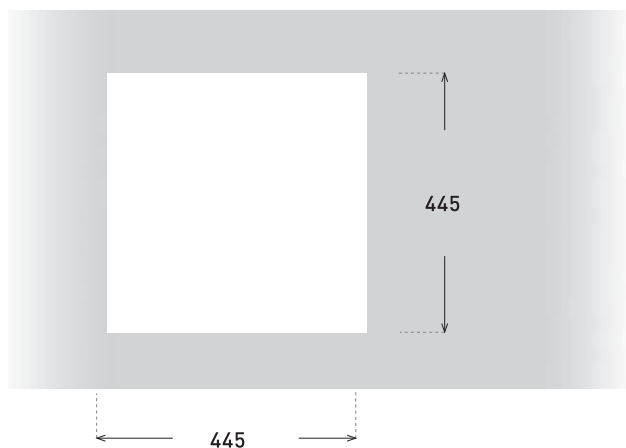

IGNIS



Para más información | For more information | Pour plus de renseignements: www.atron-europa.com

MÓDULO | MODULE 80 cm

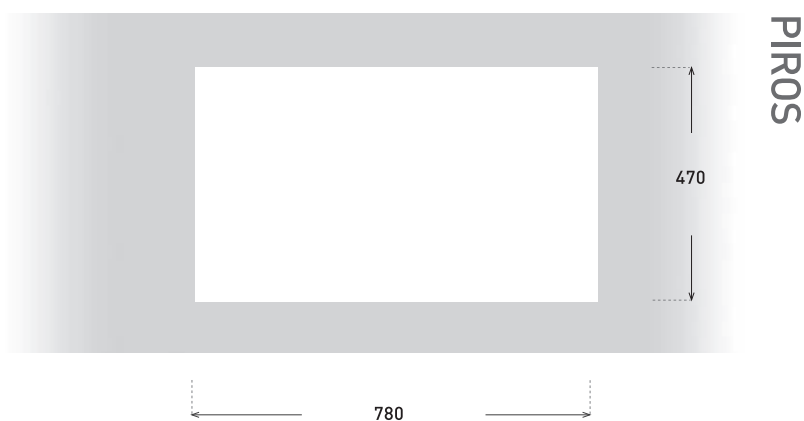

MÓDULO | MODULE 90 cm

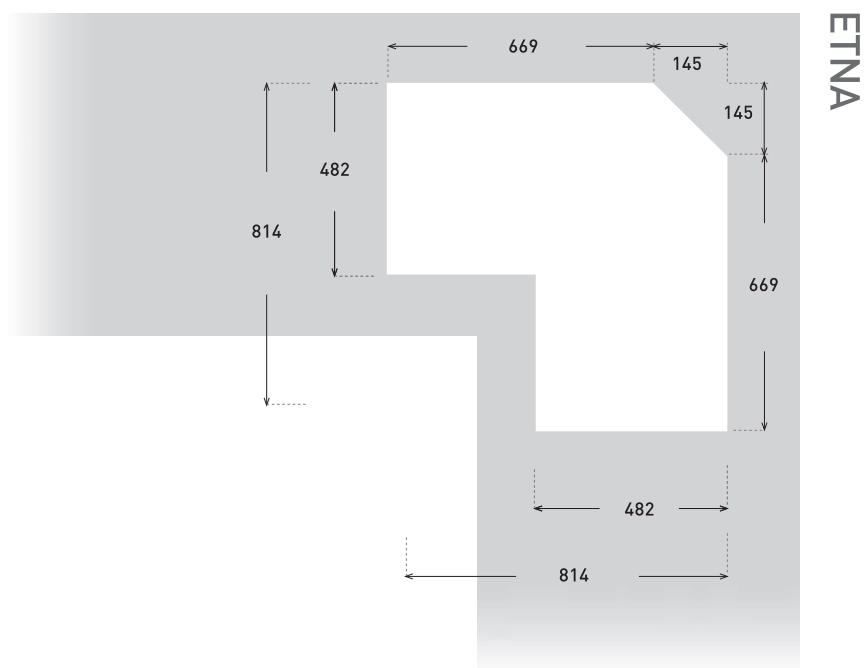

 **CLASSIC**

Para más información | For more information | Pour plus de renseignements: www.atron-europa.com

MÓDULO | MODULE 45 cm

ICARIA

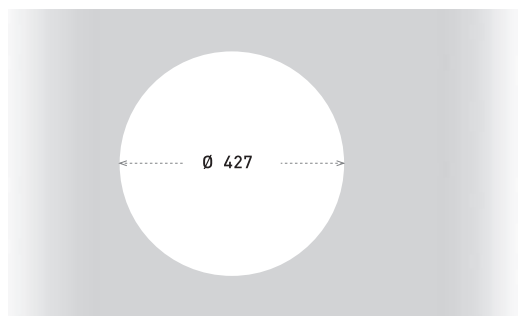

MEDEA

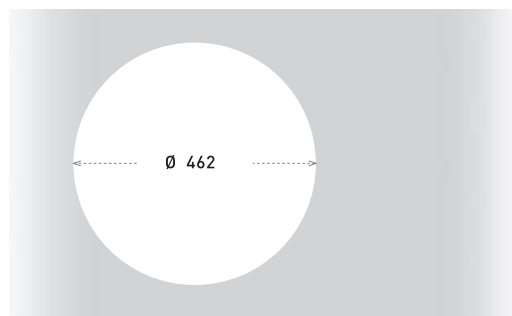

HELENA

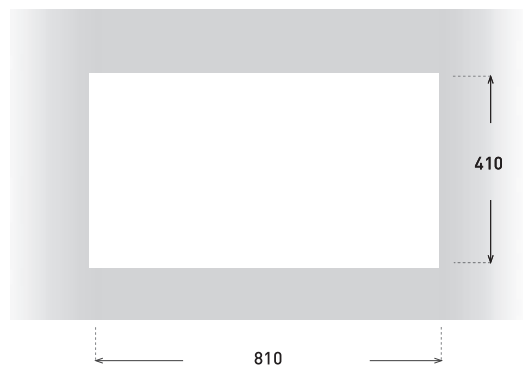

MÓDULO | MODULE 50 cm

MINERVA

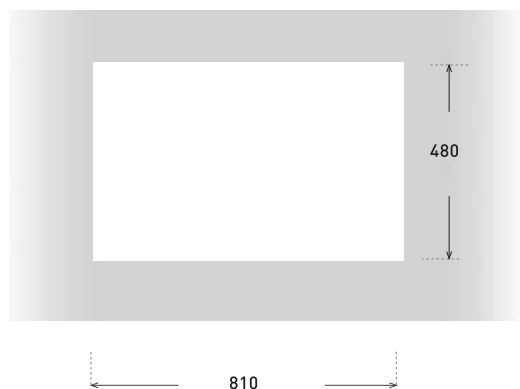

CLASSIC

Para más información | For more information | Pour plus de renseignements: www.atron-europa.com

MÓDULO | MODULE 60cm

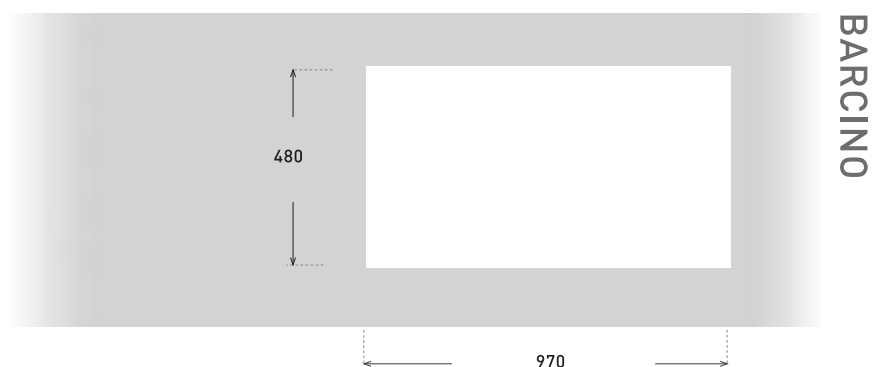
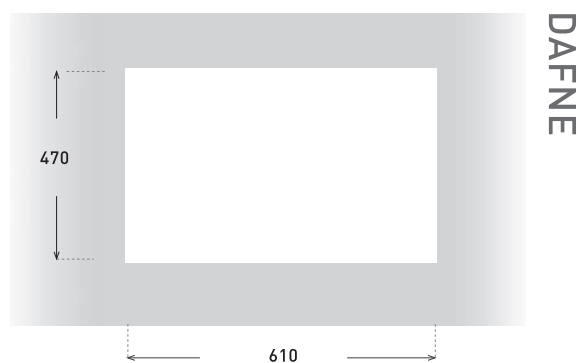
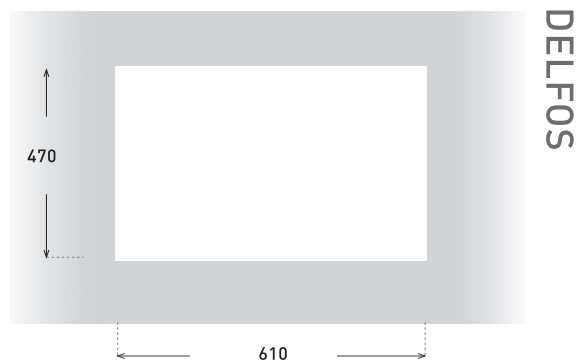

 **CLASSIC**

Para más información | For more information | Pour plus de renseignements: www.atron-europa.com

MÓDULO | MODULE 80 cm

AUGUSTA

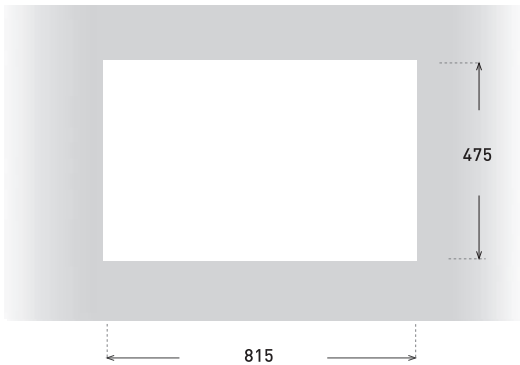

TESALIA

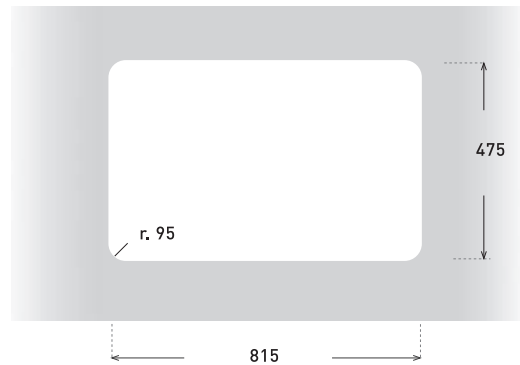

MAIA

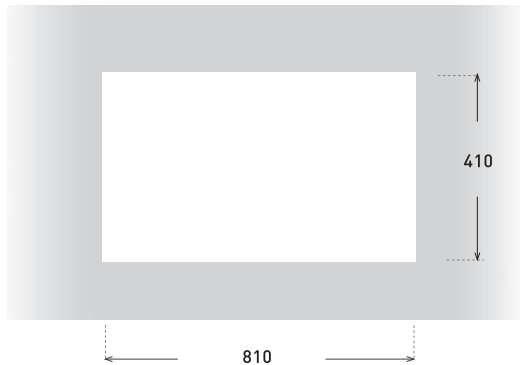

ATENEA

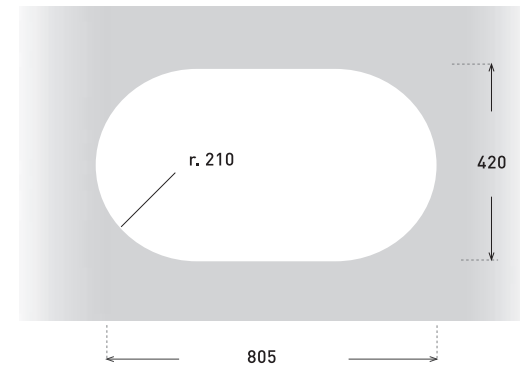

GALIA

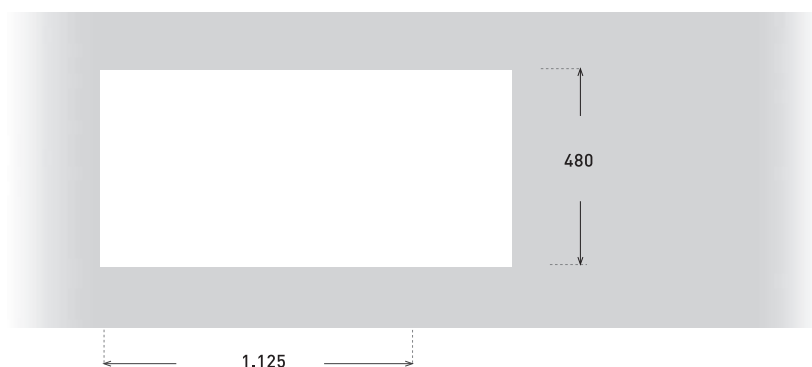

CLASSIC

Para más información | For more information | Pour plus de renseignements: www.atron-europa.com

MÓDULO | MODULE 90 x 90 cm

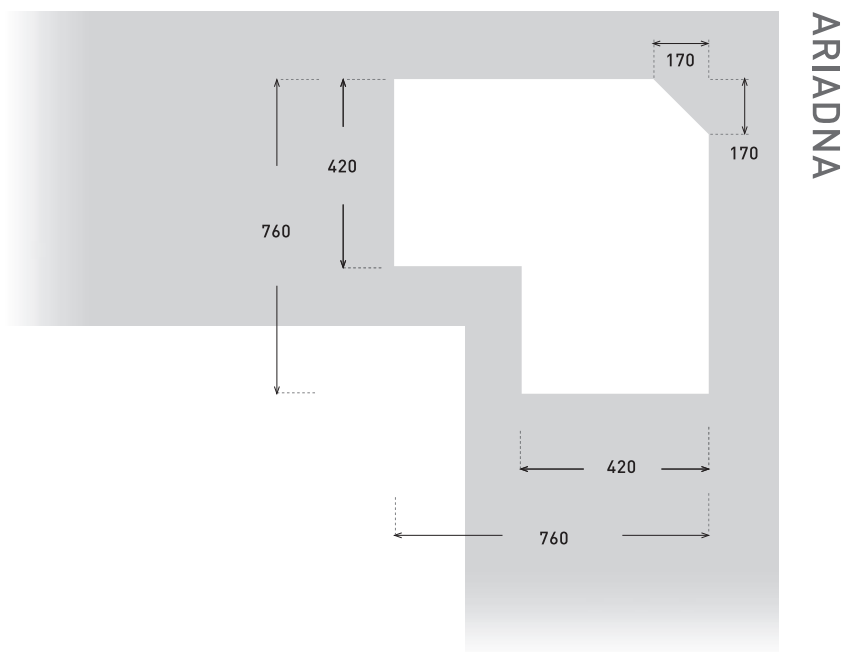

RECOMENDACIONES

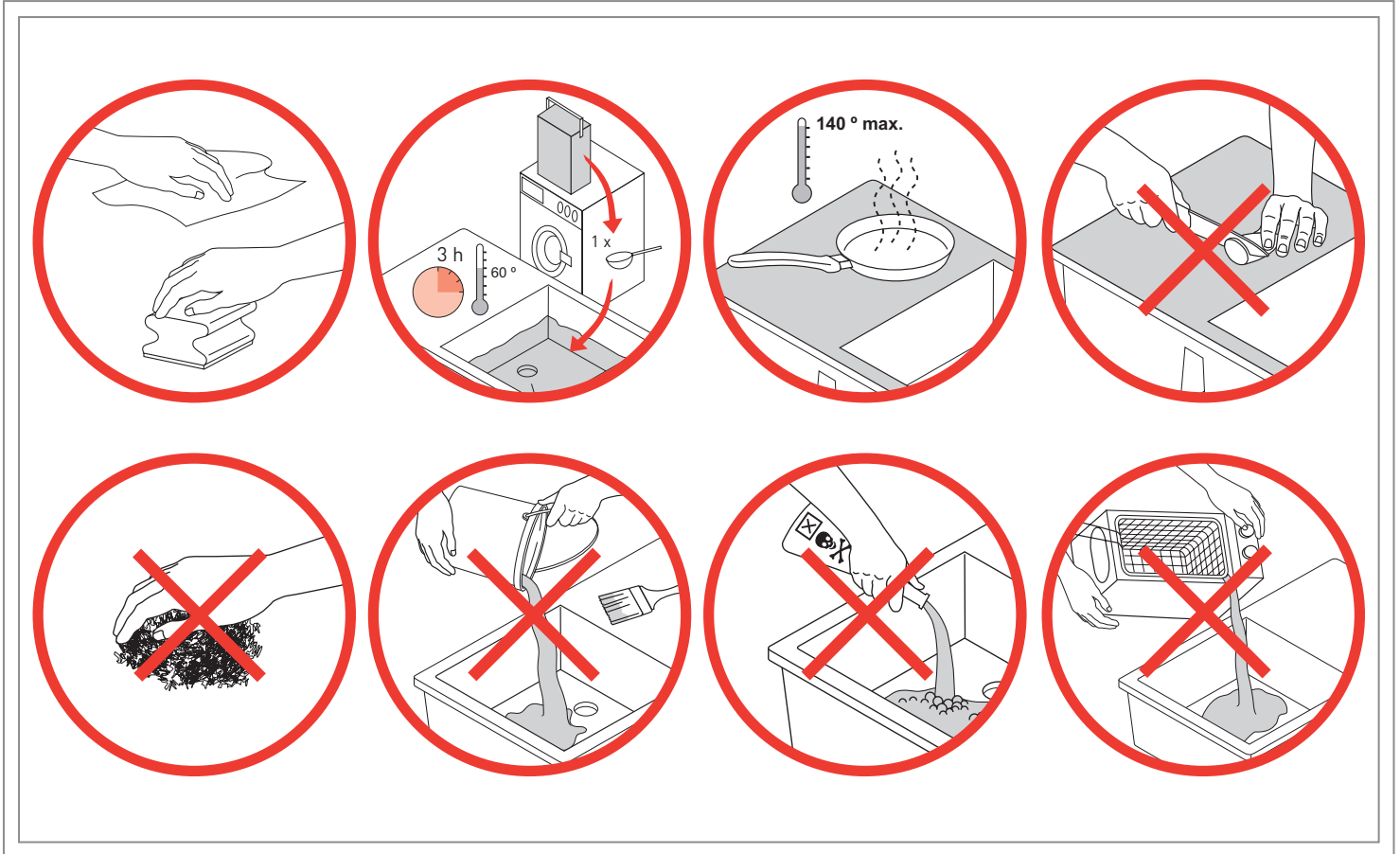

LEY DE ENVASES

PACKAGING LAW
LOI SUR L'EMBALLAGE

Dando cumplimiento a la **Ley 11/1997 de 24 de abril, de envases y residuos de envases (BOE nº 99 de 25.04.97)**, informamos al consumidor que el responsable de la entrega del residuo del envase usado para su correcta gestión ambiental es el poseedor final del mismo.

E

In compliance with the Spanish **law 11/1997 of April 24th on packaging and packaging disposal (BOE No. 99 of April 25th 1997)**, we inform our clients that the end consumer is responsible of using the appropriate containers for garbage disposal.

F

En conformité avec la loi espagnole **11/1997 du 24 avril sur l'emballage et les déchets d'emballages (BOE nº 99 du 25 avril 1997)**, nous informons les consommateurs que la livraison et la correcte gestion environnementale des déchets du récipient utilisé est sous leur propre responsabilité.

GARANTÍA

Apreciado cliente,

Los fregaderos ATRON® están compuestos de cuarzo y resinas de componente acrílico. Solamente utilizamos materiales que cumplen con la Directiva 2002/72/CE de la Comisión Europea relativa a la seguridad alimentaria. En Atron® trabajamos para ofrecer un producto coherente y uniforme. Nuestros fregaderos han sido sometidos a estrictos controles de calidad, así como a frecuentes análisis de laboratorio, efectuados por el Instituto de Tecnología Cerámica de Castelló.

Atron Línea Europa SL garantiza sus productos en referencia a los defectos de fabricación, según la Ley 23/2003 de Garantías de Venta de Bienes de Consumo. Dicha garantía es de 2 años.

El documento de garantía será la factura que le haya emitido la entidad suministradora del producto.

La garantía se limitará única y exclusivamente a la reposición sin cargo del material defectuoso, previo examen y aceptación del posible defecto de fabricación por parte de nuestro Departamento Técnico así como por parte del Departamento Comercial. No existirá bajo ningún concepto derecho al reembolso de los gastos de instalación u otros gastos asociados.

La garantía excluye cualquier defecto que sea consecuencia de una instalación o manipulación incorrectas.

Gracias por escoger un producto ATRON®.

E

Dear Customer,

ATRON® sinks are made of quartz and acrylic resins. We only use materials that comply with the EU Commission Directive 2002/72/EC on food security. Atron® strives to offer a product that is consistent and uniform. Our sinks are subject to strict quality controls, as well as frequent laboratory analyses conducted by the Institute of Ceramic Technology (Castelló, Spain).

Atron Línea Europa SL guarantees its products in terms of manufacturing defects according to the Spanish law 23/2003 on guarantees associated to consumer goods. This is a 2-year guarantee.

The guarantee document is the invoice issued by the supplier.

The guarantee covers exclusively the free-of-charge replacement in case of defective material, whenever our Technical and Commercial Departments have verified and accepted the existence of faulty manufacture. By no means the expenses related or associated to installation will be covered.

The guarantee excludes any defects resulting from improper installation or handling.

Thank you for choosing an ATRON® product.

F

Cher client,

Les éviers Atron® sont fabriqués en utilisant du quartz et des résines à composante acrylique. Nous n'utilisons que des matériaux qui répondent à la Directive 2002/72/CE de la Commission Européenne relative à la sécurité alimentaire. Chez Atron® nous travaillons pour offrir un produit cohérent et uniforme. Nos éviers ont été soumis à des contrôles de qualité stricts, ainsi que des analyses de laboratoire fréquentes menées par l'Institut de Technologie Céramique (Castelló, Espagne).

Atron Línea Europa SL garantit ses produits contre les défauts de fabrication, conformément à la loi 23/2003 sur les garanties en cas de vente de biens de consommation. Cette garantie est de 2 ans.

Le document de garantie sera la facture émise par l'entité fournisseuse du produit.

La garantie se limite uniquement au remplacement gratuit des pièces défectueuses après l'examen et l'acceptation du possible défaut de fabrication de la part de notre Service technique, ainsi que de celle du Service commercial. Il n'y aura, en aucun cas, droit au remboursement du coût de l'installation ou d'autres associés.

La garantie exclut les défauts résultant d'une incorrecte installation ou une mauvaise manipulation.

Merci d'avoir choisi un produit ATRON®.



Polígon Industrial Pla Romani
Ctra. de Vic N141-C, Km 29
Ronda de la Bòbila 14
08180 Moià · BARCELONA (Spain)

Tel.: + 34 93 830 00 30
Fax: + 34 93 830 14 58

export@atron-europa.com

www.atron-europa.com

